

Trimble bruker dagene 2019 - Lillestrøm

Mica Gavric, Magnus Norum

Nyheter i Tekla Structures



Changes in Tekla installation

- Folder structure under \ProgramData and under \Users now contains Trimble :  C:\ProgramData\Trimble\Tekla Structures\2019.0
- The **environment folder structure** renewed – easier to keep folder up to date. \Concrete , \Steel , \Engineering \General folder
- New Bridge Designer role

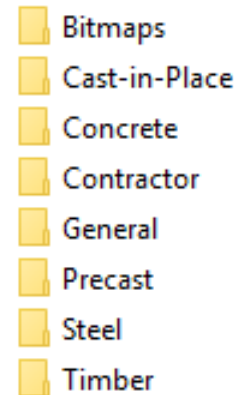
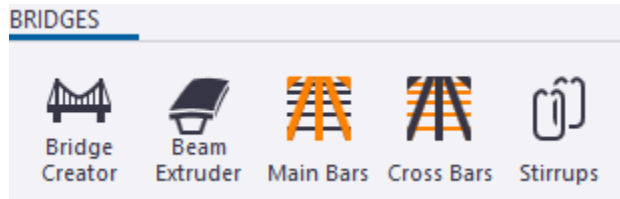

Start screen, Side pane, Ribbon font...

Tekla Structures

Log in

Recent All models **Shared models** New

NAME	CREATED	MODIFIED	USERS
New model 1	7.9.2017 8.44.44	4.12.2018 12.21.22	
New model 2	7.9.2017 9.40.49	4.12.2018 12.20.14	

Your current Tekla Structures setup:

Environment: default
Role: All
Configuration: Full

- Single pane
- Stacked panes
- Float

User interface

Toolbars

Font size (Ribbon) 11,50

Project properties

General

Project number TR-5

Name **TEKLA BRUKER DAG**

Builder Contractor

Object

Part labels, clip planes, window options

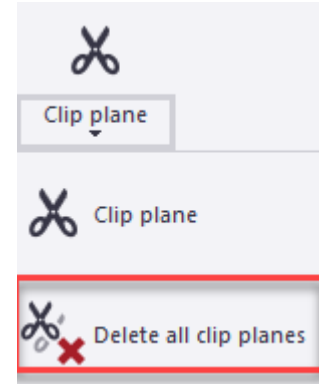
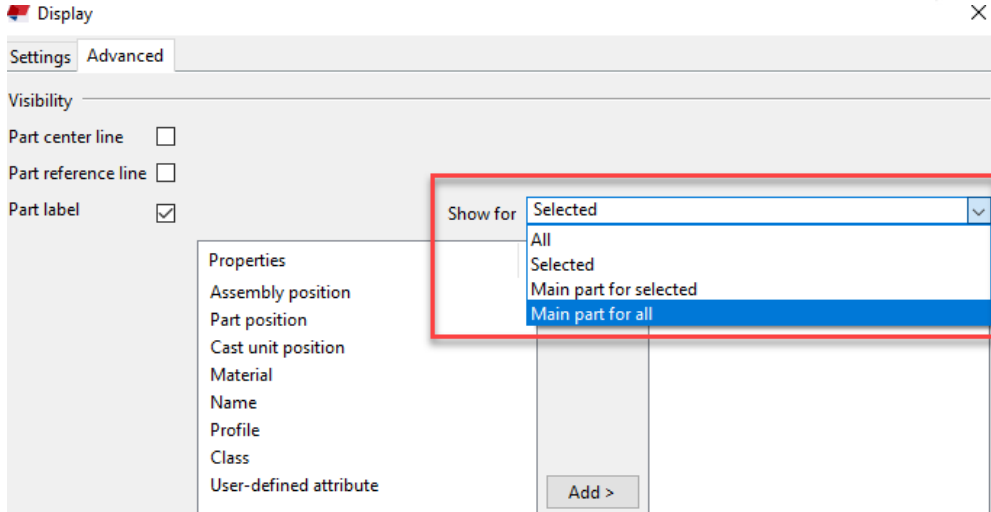

Alphabetical order →

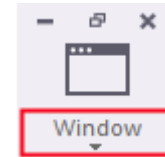

Select by identifier

- Find objects based on the specific GUIDs or Ids
- Works good also on IFC GUIDs or IFC reference objects
- Find a model object in a drawing
- Find a drawing object in a model

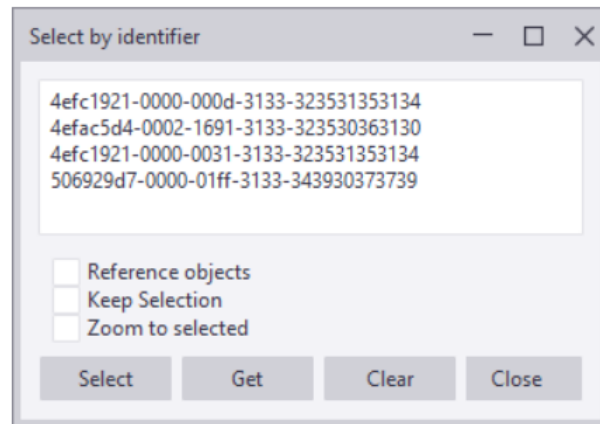
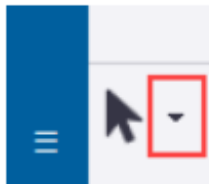

Radial grids and grid properties

- Grid color and Label font size and color = Property Pane
- Radial grid

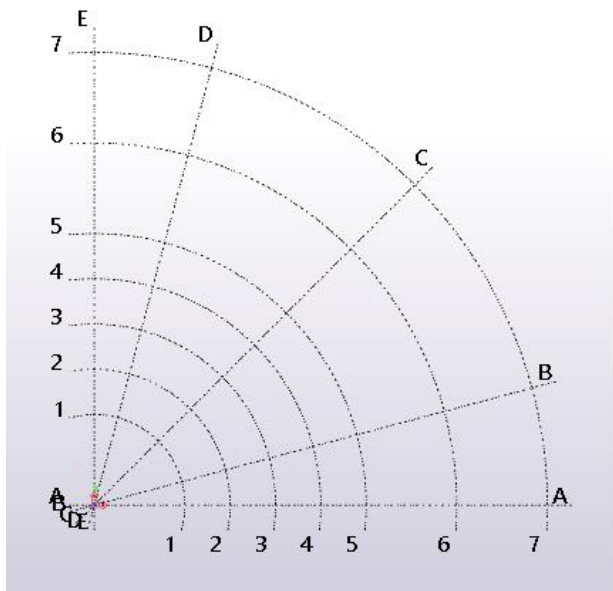

▼ Grid color

Color 

▼ Label font size and color

Font size

Font color 

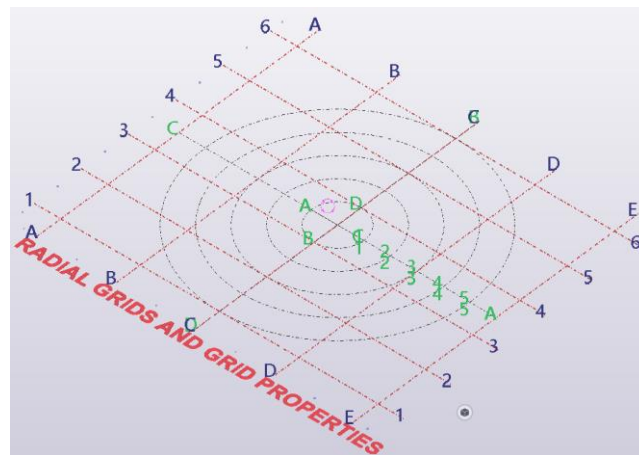

New curved construction objects

- Construction arc

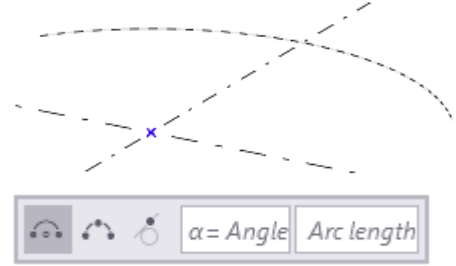
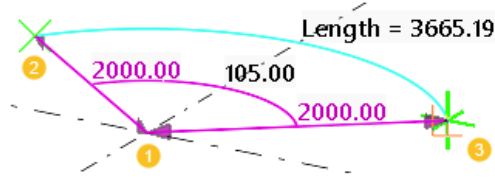

- Construction polycurve

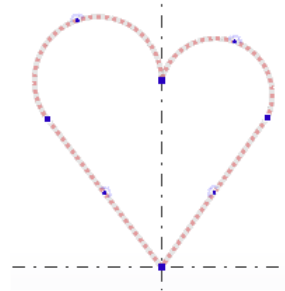

- Copy construction objects with offset
- Improvements in construction circles and lines

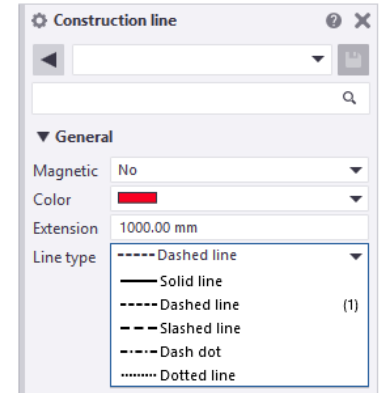

Modelling improvements

- Ortho snapping
- Improvements in bolt holes

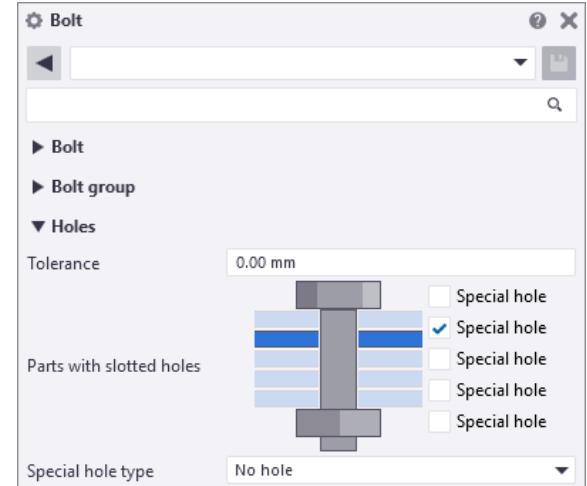
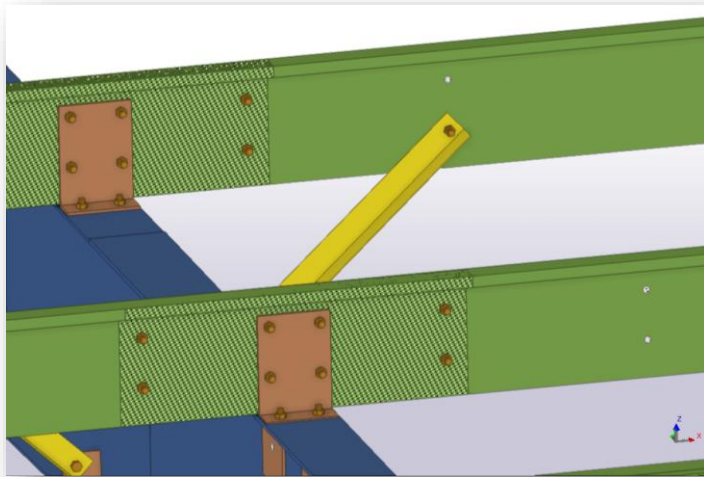

Screws, Nails, 'Self tapping' fasteners

Set all layers to create no hole

- Marks, drawings, and NC of the parts and assemblies are unaffected
- Truly accurate quantities can be obtained for fasteners

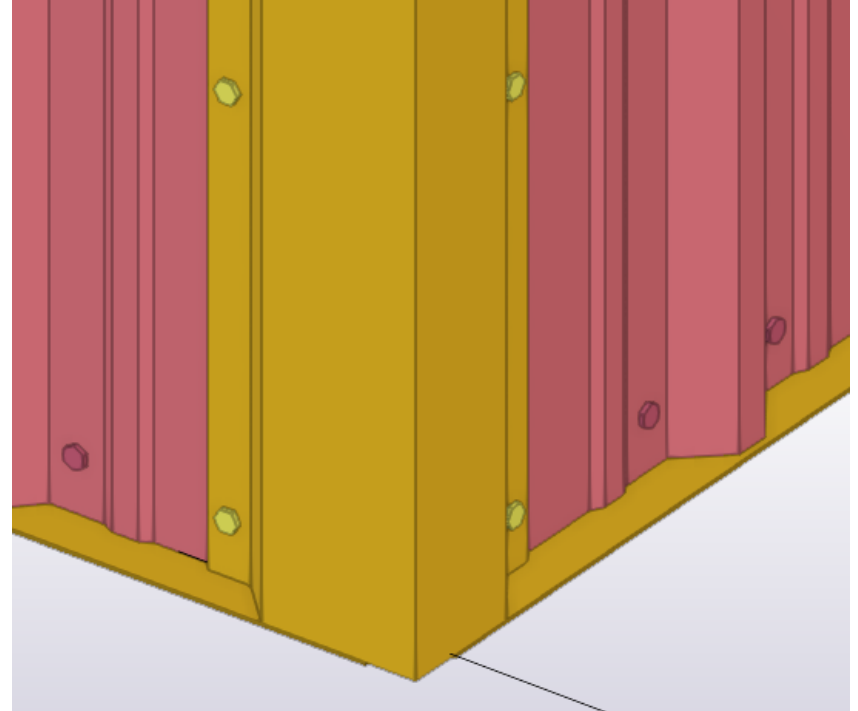

Modelling improvements

- Improvements in placing items in the model

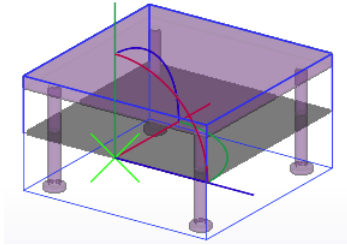

- Model search toolbar

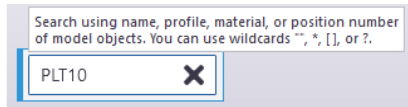

- Numbering improvements
 - Assembly phase!

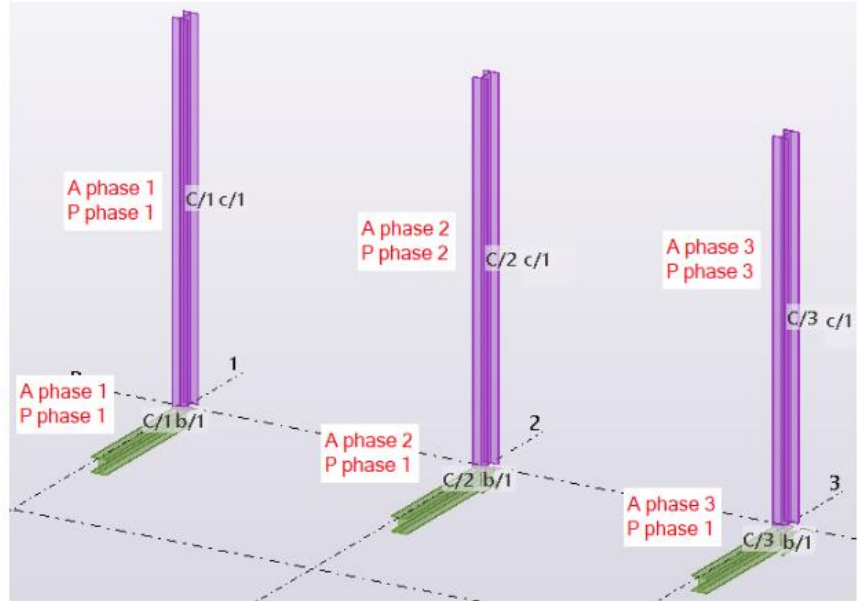

Stand-alone bent plate

On the **Steel** tab, click **Plate** > **Create stand-alone bent plate**

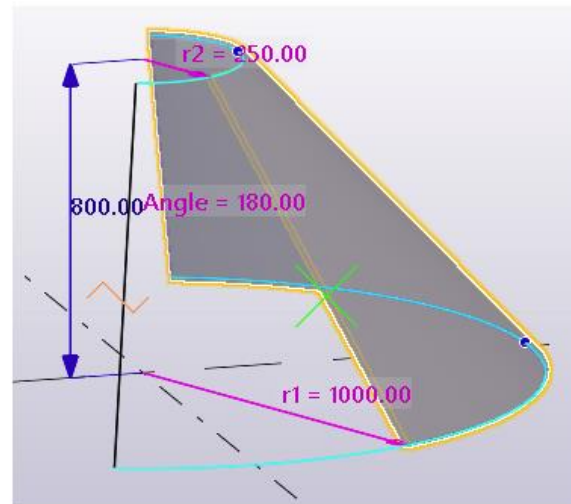
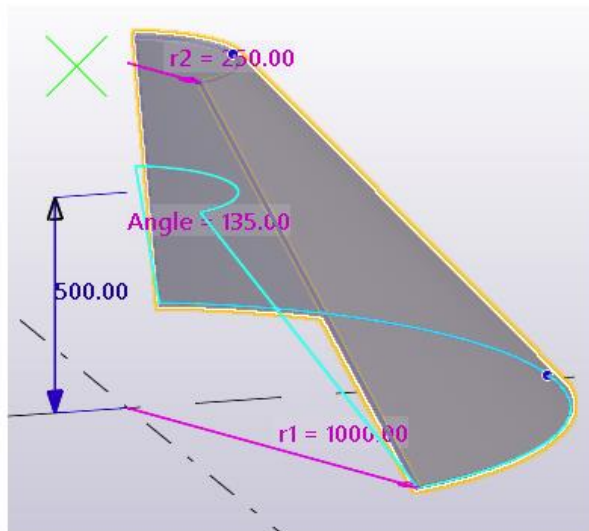
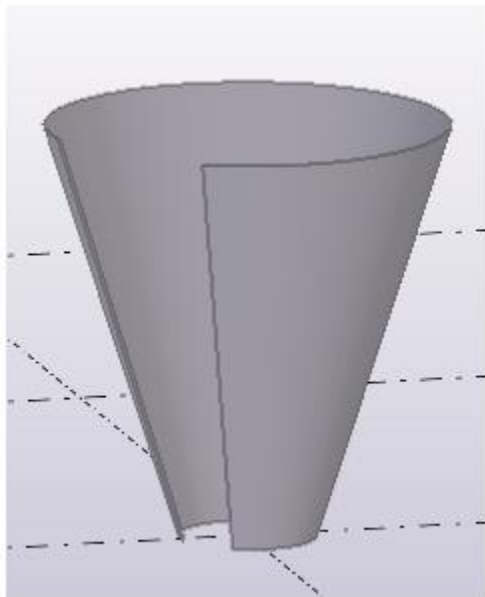

Visualizer for Tekla Structures

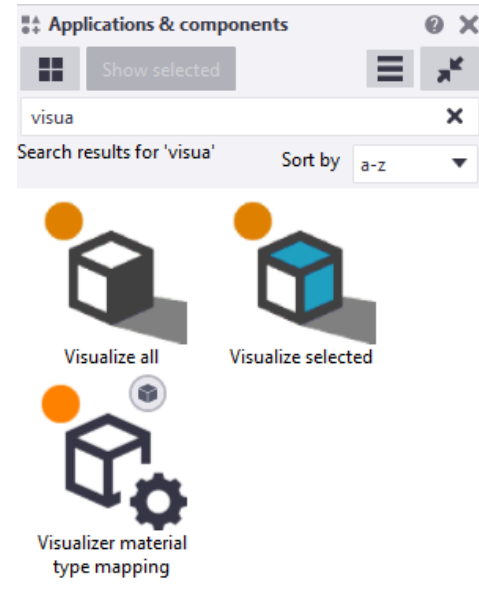

Improvements in Tekla Model Sharing

- Version control for drawings
- Check for regional settings
- Printer device settings shared
- Improved sharing performance with reference model objects
- Improved handling of conflicting modifications
- Better IT service around Model Sharing

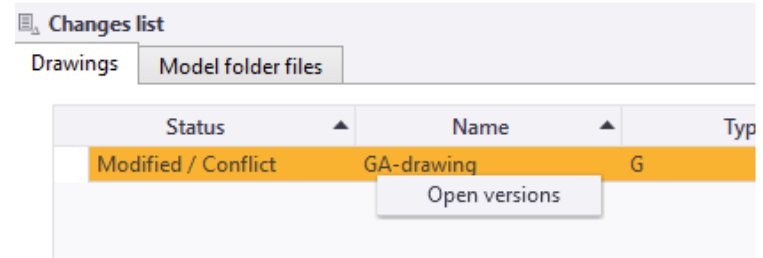

ModelChecker

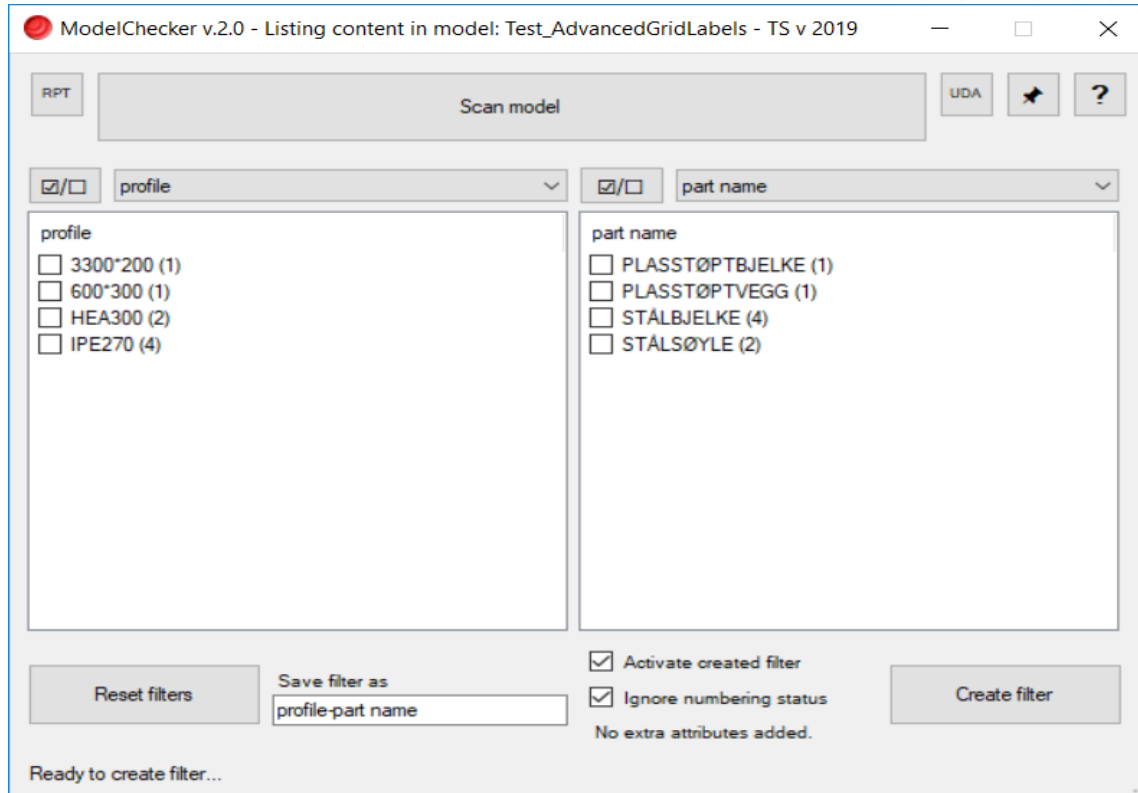

ModelChecker



ModelChecker

